

A 43-34

C 138-143

VACANT
MOUNTAIN

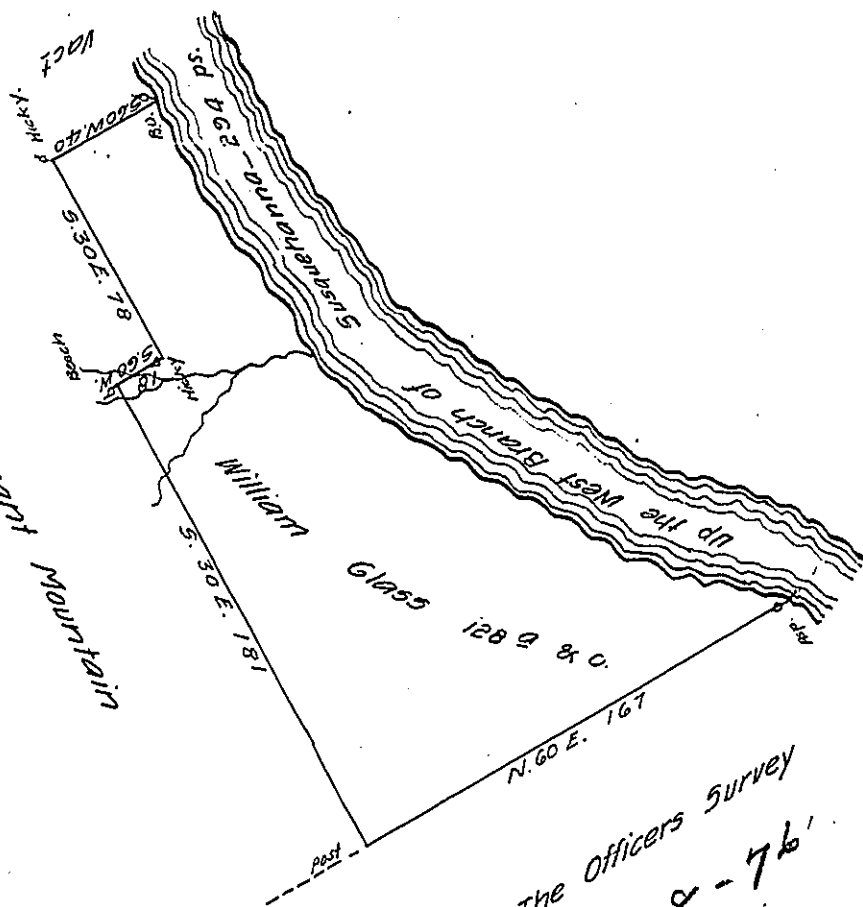

The Officers Survey
C 78-76'

A Draught of a Tract of Land Called _____ Situate
 above the mouth of Bald Eagle Creek on the south side of the West
 Branch of Susquehanna in the County of Berks, surveyed the 9th
 day of November 1769, To William Glass in pursuance of an Ap-
 plication No. 2788, dated the 4th day of April 1769. Containing
 One hundred and Twenty eight acres and allowance of six acres
 p. ct. for Roads & ca.

To John Lukens Esq.

sur Genl

Chas. Lukens D.S.

IN TESTIMONY that the above is a copy of the original remaining on file in
 the Department of Internal Affairs of Pennsylvania, made
 conformably to an Act of Assembly approved the 16th day of
 February, 1833, I have hereunto set my Hand and caused
 the Seal of said Department to be affixed at Harrisburg,
 this third day of October 1905

Geo. N. Brown
 Secretary of Internal Affairs.